

REVISED
PROPOSED RESIDENTIAL LAYOUT IN
FOR "DNYNESHWAR NAGAR" GUT NO 237
AT ASADAWAN TO DIST NANDED

AREA STATEMENT
TOTAL AREA OF LAND
AREA UNDER PRI-SCHOOL } 4000.00
AREA UNDER OPEN SPACE } 4100.00
AREA UNDER PLOTS } 21900.00
AREA UNDER ROAD } 19860.90
AREA UNDER PROPOSED LAYOUT } 40440.00

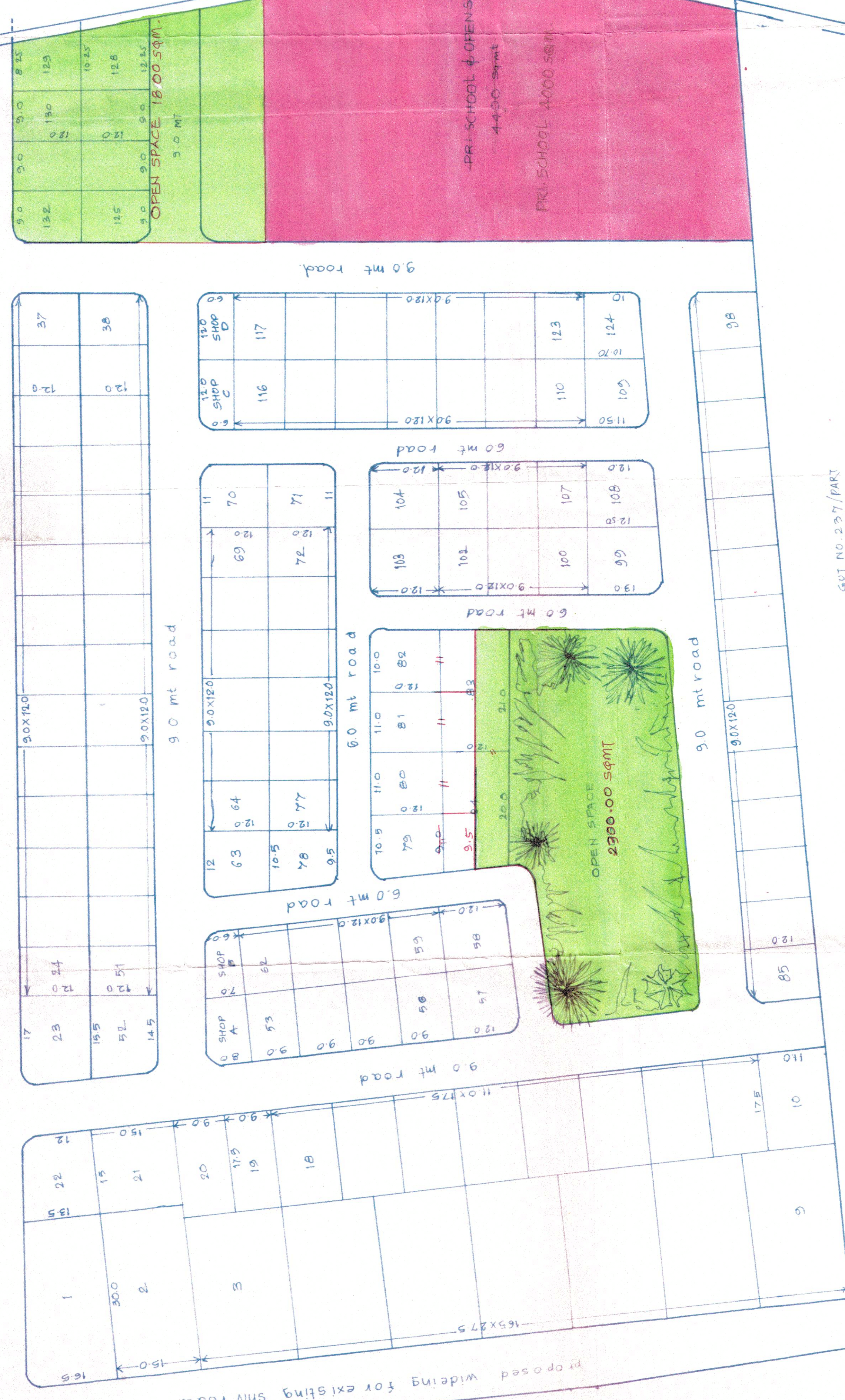

AREA IN SQMT	AREA IN SQMT
450.00	450.00
453.75	453.75
192.50	192.50
142.00	142.00
225.00	225.00
191.25	191.25
196.00	196.00
2090.00	2090.00
24 TO 51, 53 TO 56, 58 TO 62, 64 TO 69, 72 TO 77	108.00
85 TO 98, 100 TO 102, 105 TO 107, 110 TO 123, 125 TO 127	144.00
130 TO 132, 135 TO 143, 144 TO 153	110.00
97, 98, 103, 104	135.00
78, 82, 134, 135	144.00
63, 64, 128	144.00
79, 82	190.00
85	252.00
70 TO 71	132.00
84	240.00
95	153.00
106	127.00
108	174.00
109	150.20
124	111.00
133	141.00
154	441.00

SITE PLAN

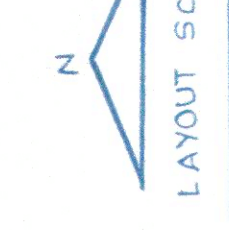
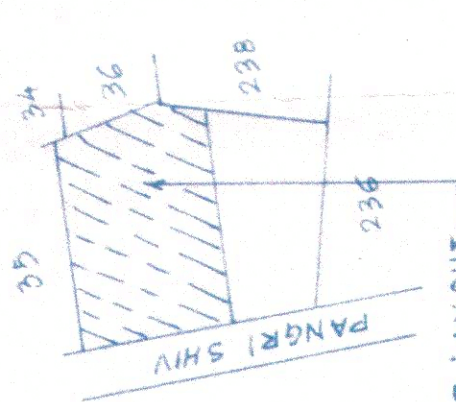

LAYOUT SCALE 1:500

Asstt. Director of
Town Planning, Nanded



APPLICANT SIGN
 Sd/-
 MIDJAMED MID-HASHAM
 Licensed Surveyor
 Pachlana, Pachlana
 Architectural & Consult Engineers
 MIDJAMED MID-HASHAM
 PACHLANA

Recommended for Approval as amended
 in Real and Subject to the conditions mentioned
 in this Office Letter No.
 21/11/10/237/PART/10/2010
 21/11/2010 236/930
 15/11/2010

Sd/-
 Assistant Director of
 TOWN PLANNING NANDED
 Sd/-